

Power Inductors Unshielded-SMT Drum 8 x 10 mm

POWER INDUCTORS

(SDIP0811LP Series)



MAX. DIM :
L = 13.46 mm
W= 9.52 mm
H = 11.70 mm

- Used in high frequency DC/DC converters.
- Energy storage of 400 μ J.
- Inductance range from 1.7 μ H to 68 μ H
- Stable inductance for increasing current
- Low profile met with flat base design

MECHANICAL SPECIFICATIONS

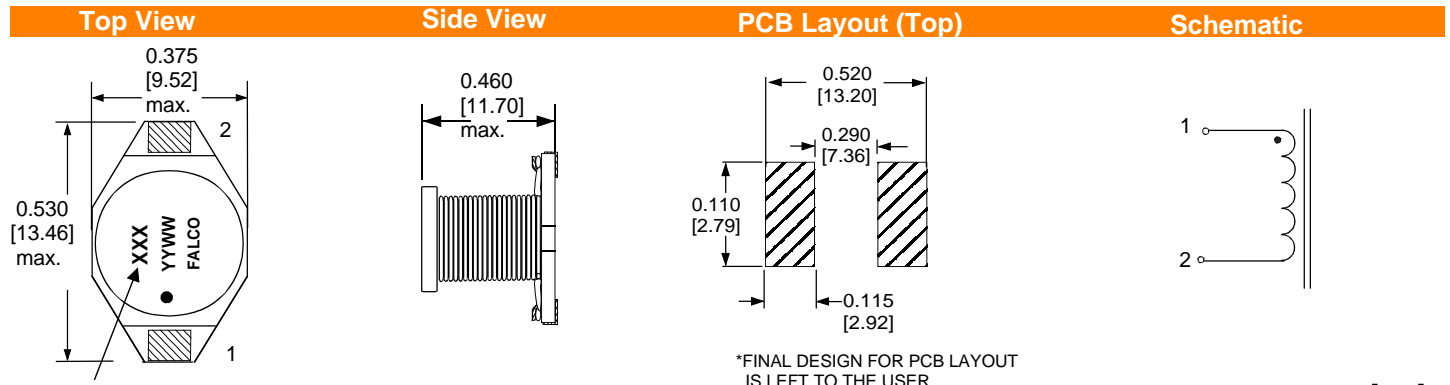

Marking Inductance Value / Add "L" letter for RoHS parts

*FINAL DESIGN FOR PCB LAYOUT IS LEFT TO THE USER

All dimensions are in inches [mm]

Packaging Information

Tape & Reel

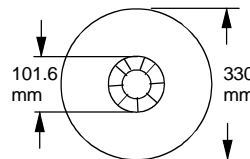
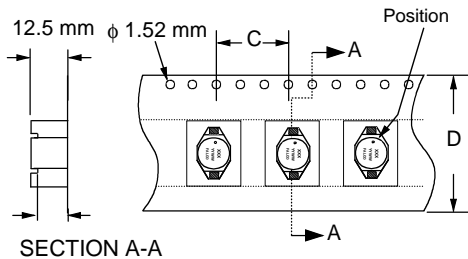

ITEM	DESCRIPTION	QTY.
A	QTY. PER REEL	300
B	QTY. PER BOX	1500
C	PITCH	16 mm
D	TAPE WIDTH	24 mm

See tape and reel information 63-003

ELECTRICAL SPECIFICATIONS

FALCO PART NUMBER	RoHS PART NUMBER	OCL(μ H) ¹ $\pm 20\%$	DCR (Ω max)	I rating ² (Amp)	I sat ³ (Amp)
D08043	D08061	1.7	0.0058	15.0	26.0
D08034	D08060	2.2	0.0072	13.0	23.0
D08040		3.5	0.0096	11.0	18.0
D08006	D08L06	4.7	0.0120	10.0	12.0
D08048		10.0	0.0199	6.5	10.1
D08049		12.0	0.0276	5.5	9.6
D08050		15.0	0.0312	5.2	9.0
	D08066	22.0	0.0500	3.7	7.5
D08057	D08L57	68.0	0.1300	2.4	4.4

1. Inductance tested at 100 KHz 0.25 V.
2. Temperature rise is 40°C Typ.
3. Inductance drop 10% Typ. at Isat.
4. Operating Temp. range -40°C to +85°C.
5. OCL and DCR tested at Ta= 25°C.



RoHS COMPLIANT PRODUCT

Power Inductors Unshielded-SMT Drum 8 x 10 mm

Inductance & Temp. Rise vs Current (SDIP0811LP Series)

